

My software solution for your service teams  
**pobvol Service Solution**  
**-Reporting & Monitoring-**

© Copyright 2024 by Inge Baumann-Pobloth

Inge Baumann-Pobloth  
pobvol Software Services  
Wolfskaulstrasse 84, 66292 Riegelsberg, Germany

E-Mail [kontakt@pobvol.com](mailto:kontakt@pobvol.com)

All Rights Reserved



**Built with  
Microsoft 365-  
Services**

# Business process (Monitoring)

## Planning

- Schedule inspection dates



## Execution

- Perform inspection, scan inventory and record results



## Report

- Automatic test report with information from your database stored centrally as a PDF file and available everywhere



## Review

- Review inspection report and adjust if necessary
- Approve report
- Automatic reminder for the next inspection
- Send report to customer by email



## Monitoring

- Use dashboard and checklists for your monitoring

# Process: Refresh the reporting files

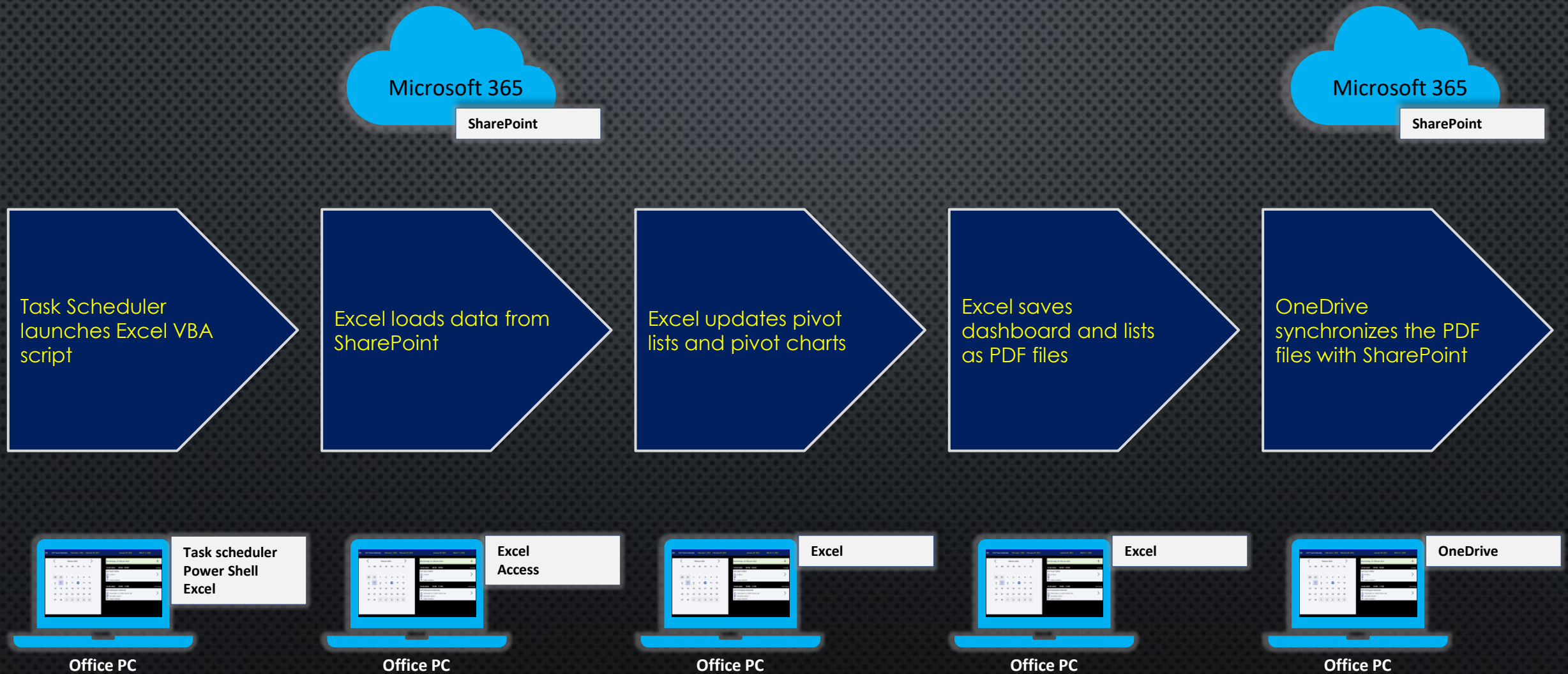

# Service Dashboard

## Service-Dashboard

pobvol pssService  
Donnerstag, 29. August 2024 12:22

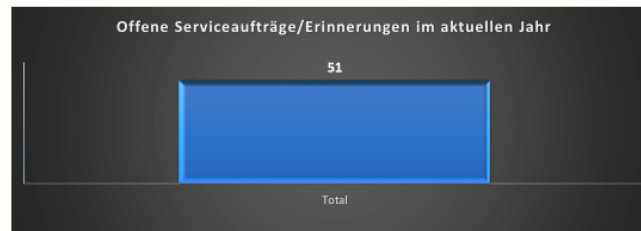
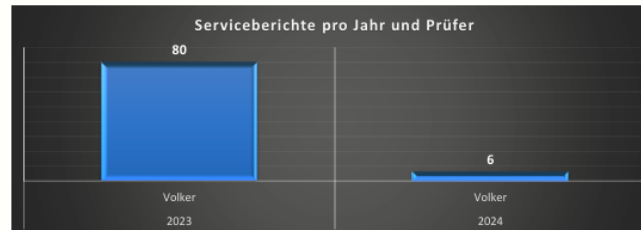

## Serviceberichte

pobvol pssService

Donnerstag, 29. August 2024 12:29

Legende:

OK = Plakette erteilt

nicht OK = Plakette nicht erteilt

Jahr	Monat	Kunde	Geräteart	Serien-Nr	OK	nicht OK
2024	8	Demo7	ETV Q 25	27-08-2024-11-29		X

## Serviceaufträge: Techniker-Einsatzplan

pobvol pssService

Donnerstag, 29. August 2024 12:29

Techniker	Startzeit	Endzeit	Titel / Ort
Volker	19.08.2024 08:30	09:30	pobvol pssService: UVV-Prüfung - Flurförderzeug - 08'24 Trierer Str. 155, D-66265 Heusweiler
	22.08.2024 12:00	13:00	pobvol pssService: UVV-Prüfung - Flurförderzeug - 08'24 Wolfskaulstr. 84, D-66292 Riegelsberg
	28.08.2024 12:00	13:00	pobvol pssService: UVV-Prüfung - Flurförderzeug - 08'24 Wolfskaulstr. 84, D-66292 Riegelsberg
	30.10.2024 09:00	09:30	pobvol Service: UVV inspection - Demo device - 10'24 1, Route de Trèves, L-2632 Findel, Luxembourg
	02.12.2024 09:00	10:00	pobvol pssService: UVV-Prüfung - Demogerät - 12'24 Köllner Str. 92, D-66292 Riegelsberg

# Power BI Report

Power BI Report



Customers



Devices



Orders



Reports



Settings



Help

## Service reports (Charts)

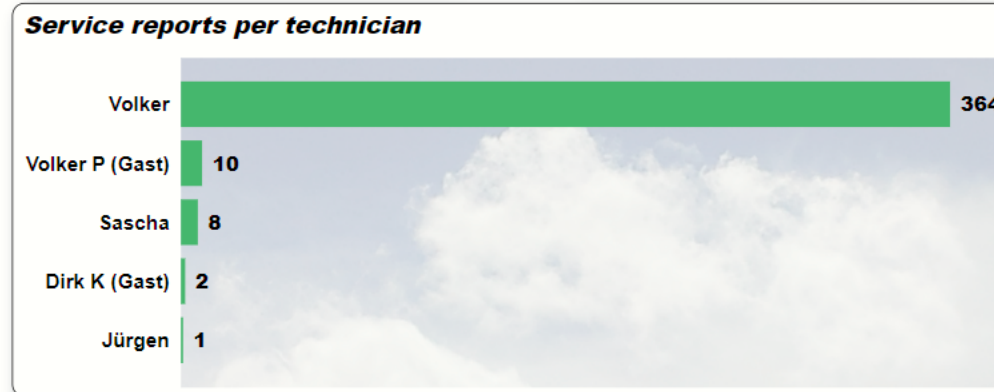
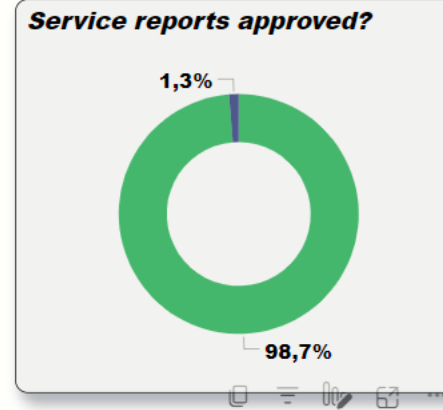
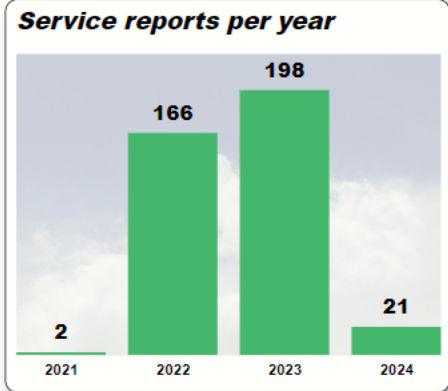

Filter

Suchen

Filter für diese Seite

Genehmigt  
ist (alle)

Servicetechniker  
ist (alle)



Servicejahr  
ist (alle)

Σ Servicedatum  
ist (alle)

Service reports (Charts)

Service reports (List)

# Prerequisites & System Requirements

- Your technicians will need a smartphone or tablet (iOS or Android). The devices must support NFC if NFC tags are to be processed.
- Your office staff can use a PC, Mac or tablet (iOS or Android).
- You need a Microsoft 365 Business Basic license or higher per user.
- If more than one team member shall manage your service orders with the solution, you need a shared mailbox and a Microsoft 365 Business Basic License or higher.
- You need a Microsoft Windows PC on which the PC component of the solution is installed and running.
- To customize and extend the PC component, you need a Microsoft Office license that includes the desktop versions of Excel and Access. This means at least a Microsoft 365 Apps for Business License or a Microsoft Office Professional License.
- For information about the system requirements, see the [Microsoft 365 and Office Resources](#)  page.
- Microsoft's minimum requirements for using Power Apps are provided on the [Microsoft System requirements, limits, and configuration values for Power Apps](#)  page.



# Copyright

- This document and the information contained therein as well as the associated logos are the property of Inge Baumann-Pobloth, Riegelsberg, Germany and protected by laws and international agreements.
- Any distribution or reproduction of this document or parts thereof without written permission is expressly prohibited and will result in civil and criminal penalties.
- This document may include components that are the property of other software vendors. Other product and service names mentioned in this document, as well as their associated logos, are the property of, and may be trademarks of, their respective companies.
- This document is provided "as is" and is subject to change without notice.
- The information in this document is non-binding and for informational purposes only. I do not warrant the accuracy or completeness of the information, text, graphics, links or other items contained in this document. I assume no responsibility for errors or omissions in this document.
- I assume no liability for damages of any kind, including without limitation, direct, special, indirect or consequential damages in connection with the use of this document.
- The information you may access through the links contained in this material is not under my control and I make no warranties or representations whatsoever about any third party websites.
- All rights reserved.

Inge Baumann-Pobloth  
pobvol Software Services  
Wolfskaulstrasse 84  
66292 Riegelsberg, DE  
E-Mail: [kontakt@pobvol.com](mailto:kontakt@pobvol.com)